

## APPLICATION FOR A NEW GRANT OF A PREMISES LICENCE

### 'TOBERMORY', 11A MAIN STREET, TOBERMORY, ISLE OF MULL, PA75 6NU

#### **LSO**

This is an application for an off sales premises. The premises will occupy the ground floor of a two storey building. The applicant intends to operate a dedicated off sales to the front of the premises offering local beers, tastings and online sales. A micro-brewery will occupy the rear of the premises.

#### Description of Premises

It is suggested that if this licence is granted the following wording be recorded on the front of the premises licence –

*“The Premises comprise an off sales shop, offering local beers, tastings and online sales, with a micro-brewery to the rear.”*

#### Off Sales Hours

The applicant intends trading to the statutory off sales hours of 1000 to 2200 daily.

#### Seasonal Variation

The applicant has withdrawn the proposed seasonal variation recorded in the submitted operating plan.

#### Tastings and Online Sales

The *Any Other activities* Box, at Q5(f), in the operating plan, should include reference to tastings and online sales. The LSO will liaise with the applicant in relation to the requirements of online/remote selling.

#### Children and Young Persons Access

As these premises will be a dedicated off sales, and there is not an on sales element to the application, the proposed wording in the operating plan is redundant and should be removed and replaced with N/A.

#### Capacity

The applicant has been advised that in an off sales premises, the capacity figure is the total area given over to the display of alcohol, not the number of persons accommodated. The applicant has revised his submission and the total alcohol display capacity is 5.56m<sup>2</sup>. This figure should be written into the operating plan at Q7. These premises are a dedicated off sales selling alcohol and merchandising. Accordingly, the whole of the retail floor area is given over to the display of alcohol and therefore a percentage figure for alcohol display is not required.

The applicant has submitted a fresh layout plan with the relevant measurements attached and appropriate legend. The alcohol display areas are marked 1 & 2 on the plan -

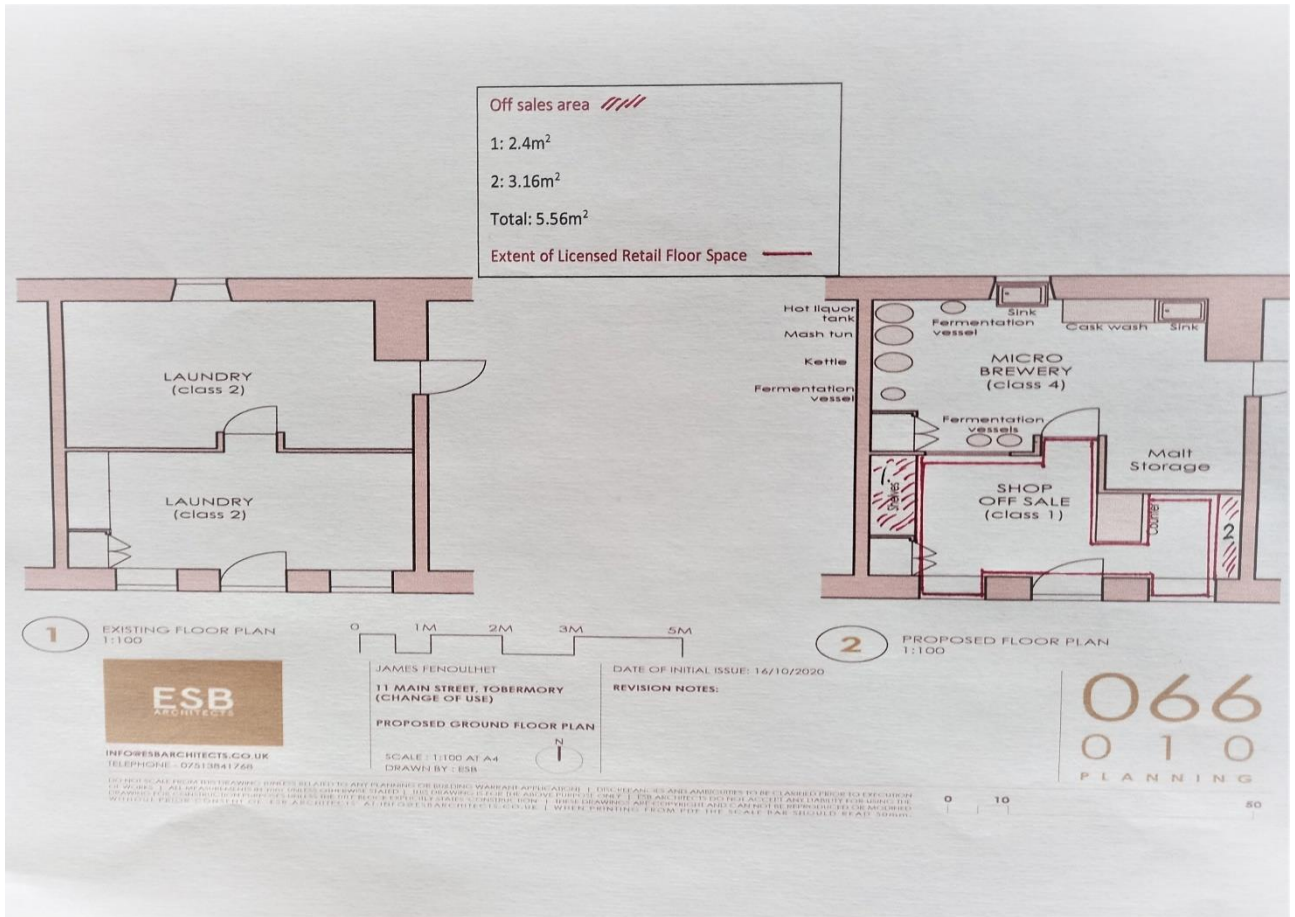

**EHO**

The EHO is aware of this application and is working with the applicant in compiling a Covid-19 Risk Assessment for the premises.